



SERVICE LETTER

No. 630

Piper Aircraft Corporation

Lock Haven, Pennsylvania, U.S.A.

September 13, 1972

Subject:

Lubrication of Fuel Valve Selector Mechanism

Models Affected:

PA-23-235 Apache
PA-23-250 (Six Place) and
PA-E23-250 (Six Place) Aztecs
PA-31 and PA-31-300 Navajo
PA-31P Navajo

Serial Numbers Affected:

27-505 to 27-622 incl.

27-2223 to 27-4860 incl.
31-2 to 31-846 incl.
31P-1 to 31P-78 incl.

Compliance Time:

Recommended within the next 100 hours of operation.

Purpose:

Field feedback information received to date concerning operation of the fuel selector system external components indicates a need for additional inspection and maintenance information, particularly in the area of system lubrication.

This service release provides instructions to check various points in the fuel selector system from the selector quadrant through control cables and linkages to the fuel valve for excessive friction, and to recommend lubrication at certain points in the system with Esso "Beacon 325" grease (MIL-G-3278).

Instructions:

See sketch on reverse side of this letter for an illustration of system friction check points and lubrication directions.

Material Required:

Esso "Beacon 325" grease or equivalent, conforming to Mil spec MIL-G-3278.

Availability of Parts:

Your Piper Dealer.

Effectivity Date:

This Service Letter is effective September 25, 1972.

Summary:

This service release is submitted to affected Piper owners and operators to insure recognition of the importance of proper fuel control system inspection and maintenance procedures. Please make arrangements with your Piper Dealer to comply with the provisions of this service release at your next regularly scheduled periodic inspection interval.

INSTRUCTIONS

1. Lubricate the following points with Esso "Beacon 325" Grease or equivalent (MIL-G-3278).

- (A) External parts of fuel selector valve sprocket.
- (B) Control cable swivel fittings.
- (C) Switch actuating arm pivot point.

2. Operate fuel selector handles with the control cables disconnected at the fuel selector valves to insure that the control cable system operates freely.

3. Reconnect control cables to the fuel selector valves and adjust according to the appropriate Service Manual Instructions.

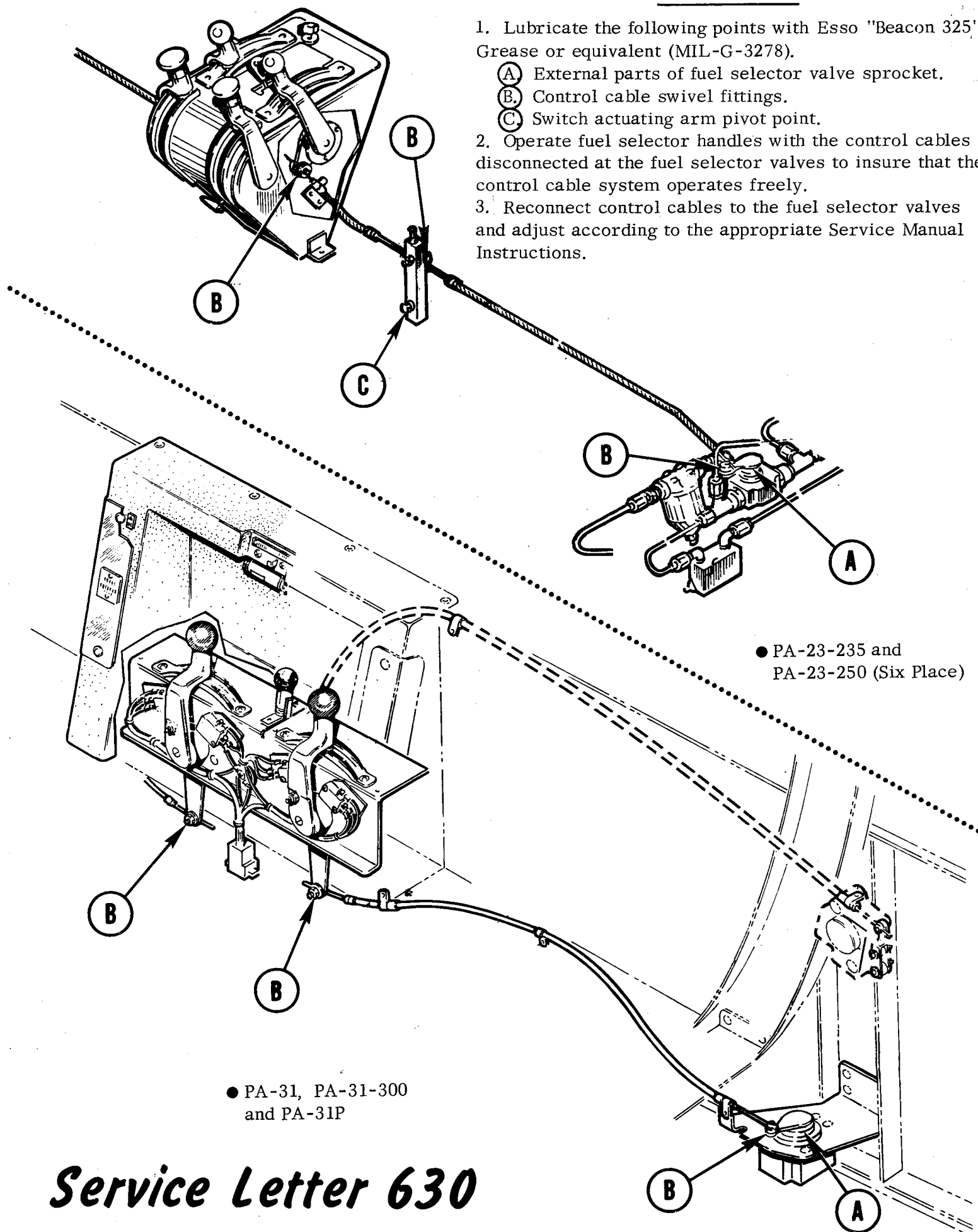

● PA-23-235 and
PA-23-250 (Six Place)

● PA-31, PA-31-300
and PA-31P

Service Letter 630